

Previous
Screen

Tooling
Options

Table of
Contents

Magna-Tite®

An applied watertight sealant makes this rivet especially suitable for oversize holes and repair applications. A large blind-side footprint also makes the fastener ideal for installation in thin or low-strength materials such as aluminum, fiberglass and plastic.

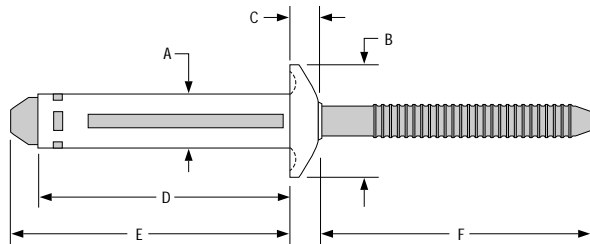
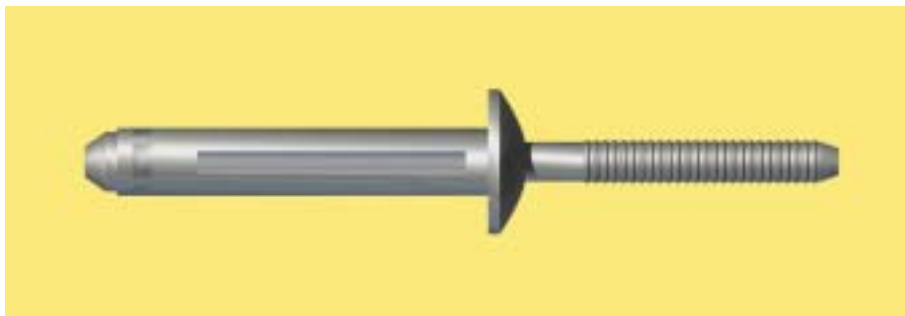

Specifications—Protruding Head Hole Size nom=.205-.221 A=.199 B=.453 C=.117 F min=.940

Dia. (No.)	Part No.	Grip Range	D max	E max
3/16 (6)	MTP-B6-5S	.050 - .312	.890	1.020
	MTP-B6-6S	.100 - .375	.940	1.070
	MTP-B6-8S	.250 - .500	1.090	1.220
	MTP-B6-10S	.375 - .625	1.215	1.345
	MTP-B6-12S	.500 - .750	1.340	1.470

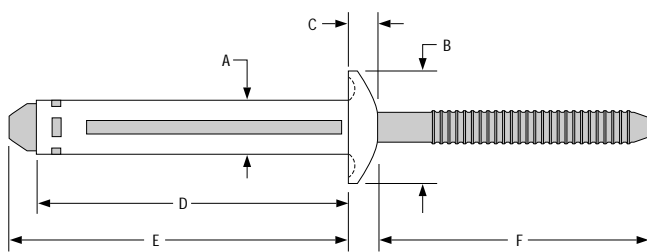

Specifications—Protruding Head Hole Size nom=.250-.263 A=.240 B=.530 C=.120 F min=.950

Dia. (No.)	Part No.	Grip Range	D max	E max
1/4 (8)	MTP-B8-4S	.040 - .250	.825	.990
	MTP-B8-6S	.125 - .375	.955	1.120
	MTP-B8-7S	.160 - .410	.985	1.150
	MTP-B8-8S	.250 - .500	1.075	1.240
	MTP-B8-10S	.375 - .625	1.200	1.365
	MTP-B8-12S	.500 - .750	1.325	1.490

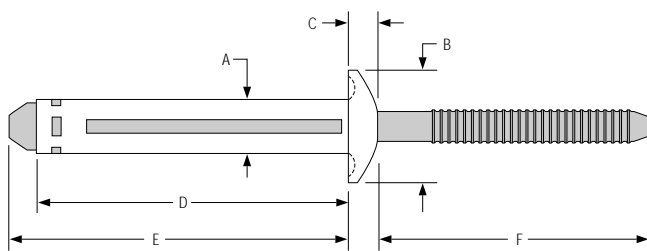

Specifications—Shavable Head Hole Size nom=.205-.221 A=.199 B=.453 C=.117 F min=.940

Dia. (No.)	Part No.	Grip Range	D max	E max
3/16 (6)	MTS-B6-8S	.050 - .500	1.010	1.140
	MTS-B6-12S	.050 - .750	1.260	1.390



Previous
Screen

Tooling
Options

Table of
Contents

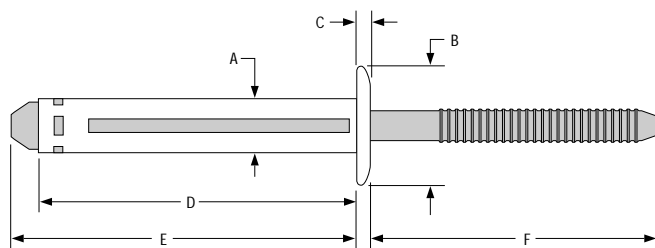

Specifications—Low Profile (non-structural) Hole Size nom=.205-.221 A=.199 B=.453 C=.052

Dia. (No.)	Part No.	Grip Range	D max	E max	F min
3/16 (6)	MTLP-B6-4	.050 - .250	.840	.970	1.189
	MTLP-B6-8	.187 - .500	1.090	1.220	.939
	MTLP-B6-12	.375 - .750	1.260	1.390	1.143
	MTLP-B6-12X	.050 - .750	1.260	1.390	1.143

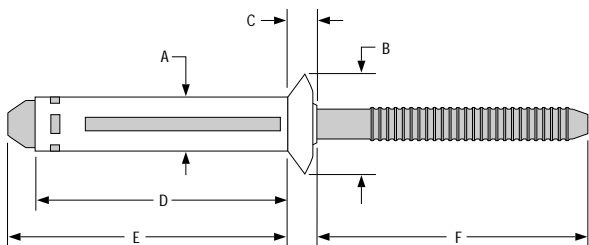

Specifications—100° Countersunk Oval Head Hole Size nom=.205-.221 A=.199 B=.355 C=.117 F min=.940

Dia.	Part No.	Grip Range	D max	E max
3/16	MTV-B6-5S	.070 - .312	.910	1.040
	MTV-B6-7S	.160 - .410	1.010	1.140
	MTV-B6-8S	.250 - .500	1.090	1.220
	MTV-B6-10S	.375 - .625	1.215	1.345
	MTV-B6-12S	.500 - .750	1.340	1.470

Installed Values in Nominal Grip (lbs.)

		Head Styles:			
		Protruding	Shavable	Low Profile	Oval
3/16	Shear	630	630	630*	630
	Tensile	450	450	450	450
	Pin Retention	90	90	90	90
1/4	Shear	1100			
	Tensile	650			
	Pin Retention	100			

In Minimum Grip. 350 lb. Shear Strength Over Minimum Grip.

Material

Sleeve	Aluminum
Pin	Aluminum



Previous
Screen

Tooling
Options

Table of
Contents

Installation Tooling

Dia.	Installation Tool	Nose Assembly		Type
3/16	2015	125280 (Insert)		Pneudraulic
	202	99-3310F/P	99-3311F/P	Pneudraulic
	2480	99-3310F/P	99-3311F/P	Hydraulic
1/4	2015	125280 (Insert)		Pneudraulic
	202	99-3312F/P		Pneudraulic
	2480	99-3312F/P		Hydraulic

F--For use with Low Profile and Shavable Head styles. Replacement insert #123021
P--For use with Protruding and Oval Head styles. Replacement insert #124185

Extended Library of Nose Assemblies
for Magna-Tite Blind Rivets

Installation Sequence

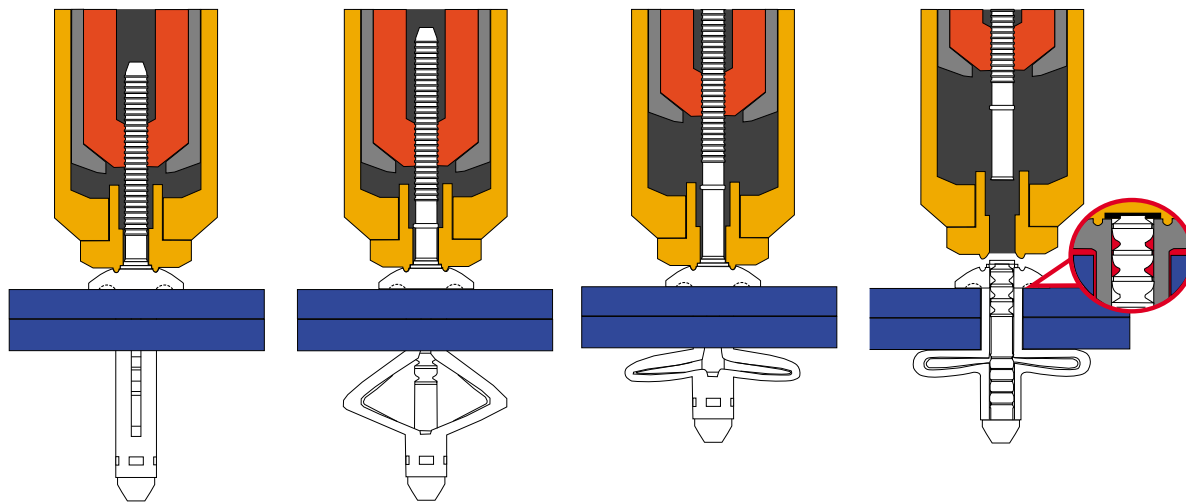

[Click Here to view animation of installation sequence](#)

**(Solid rivet-look parts may be shaved after pintail is clipped)*

Part Number Identification

MT P - B 6 - 8 (S)

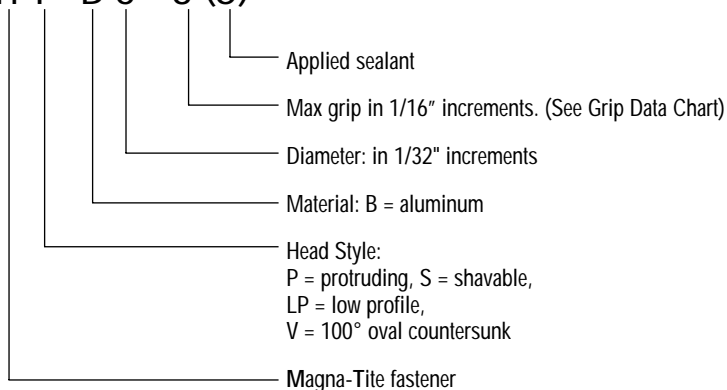

Magna-Tite®

